

MANUAL PART

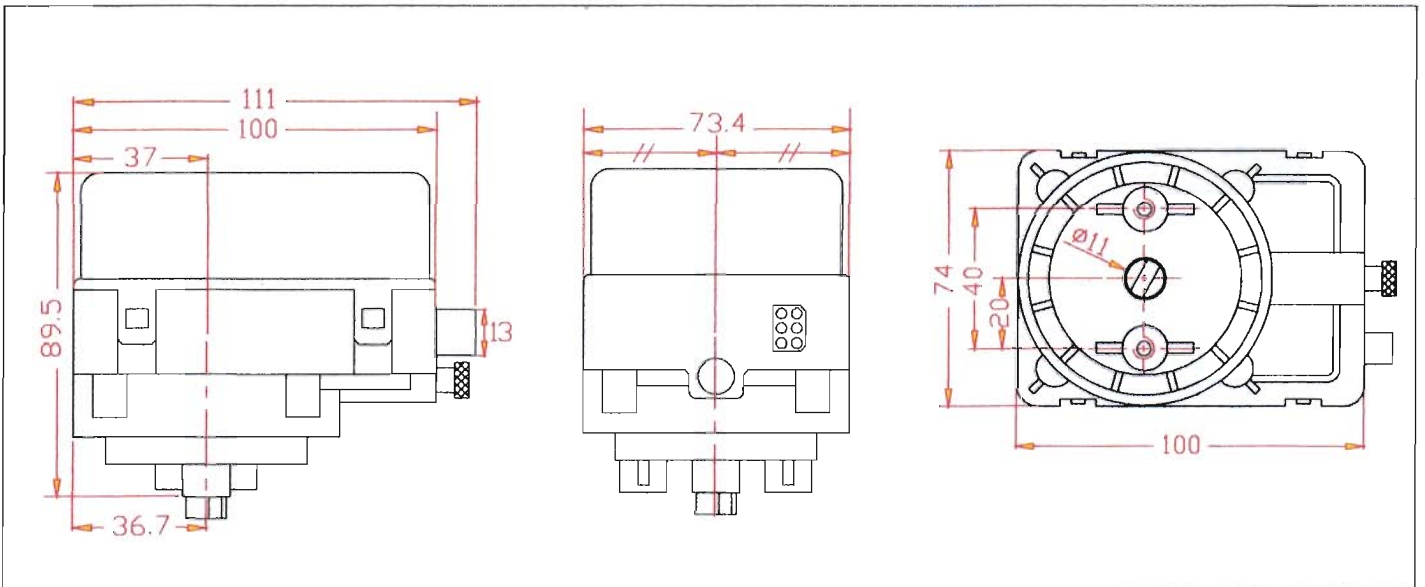

Specifications

Voltage	AC110V	AC220V	DC24V / 50-60Hz
Input Power (W)	5W	5W	
Input Current(A)	70mA	30mA	50mA
On / Off Time	25sec	60sec	
Torque Maxi	10N-M		
Weatherproof	IP54		
Fluid Temperature	-20°C ~ +60°C		
Peripheral Moisture	Below 90%RH		
N.W.	0.8kg		



Description of Manual part

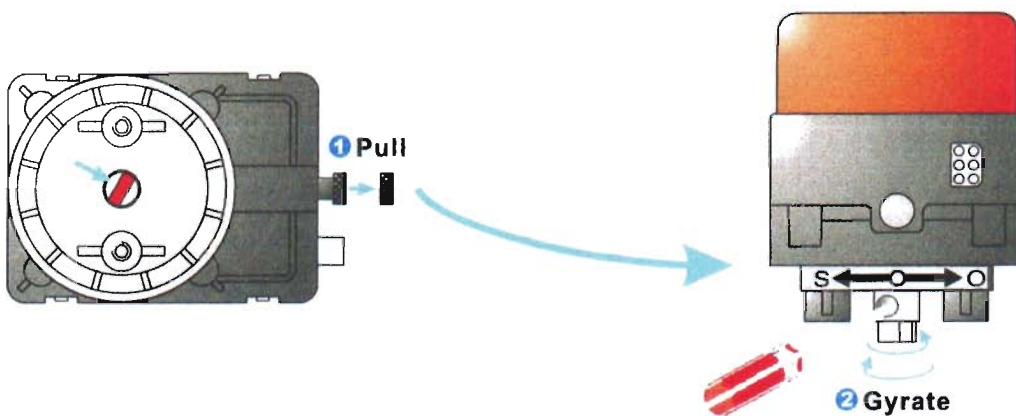



water Normal lukewarm	Steam	Cold brine	Air condition	Chemical engineering	Heat medium
●	✗	✗	●	✗	✗

- 3/4" - 1" (BSPT)
- Fluid Temp 2°C-70°C
- Max close-off pressure 8kg
- 2way, 2-piece
- Working pressure 14kg
- N.W. 3/4" - 1Kg
1" - 1.48Kg

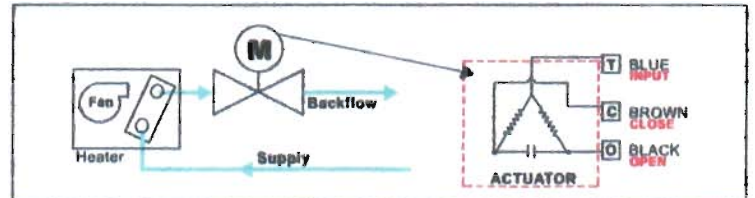
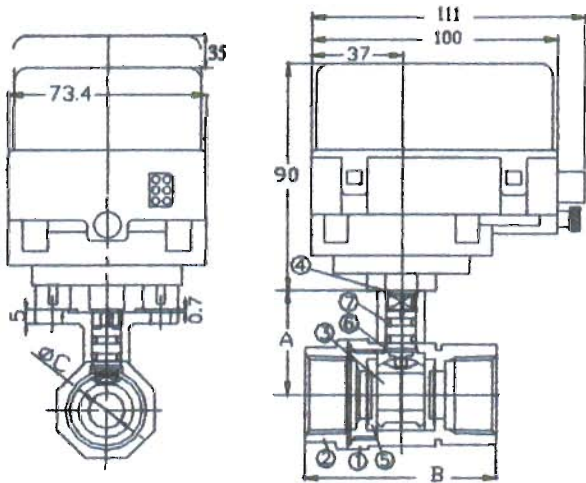

DIMENSIONS (MM)				NO.	PART NAME	MATERIAL
SIZE	A	B	∅C	1	BODY	BRASS
3/4"	28.5	62	∅15	2	CAP	BRASS
1"	50.5	80.6	∅25.4	3	BALL	BRASS
				4	STEM	BRASS
				5	SEAT RING	PTFE
				6	GASKET	PTFE
				7	O-RING	FLUORO RUBBER



water Normal lukewarm	Steam	Cold brine	Air condition	Chemical engineering	Heat medium
●	✗	✗	●	✗	✗

- 3/4" - 1" (BSPT)
- Fluid Temp 2°C-70°C
- Max close-off pressure 8kg
- 3way / T port
- Working pressure 14kg
- N.W. 3/4" - 1.1Kg
1" - 1.63Kg

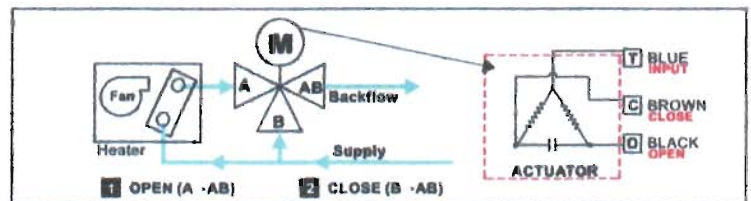
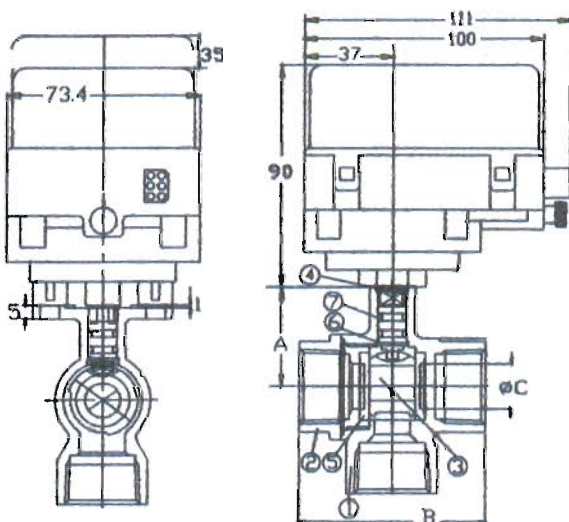

NO.	PART NAME	MATERIAL
1	BODY	BRASS
2	CAP	BRASS
3	BALL	BRASS
4	STEM	BRASS
5	SEAT RING	PTFE
6	GASKET	PTFE
7	O-RING	FLUORO RUBBER

DIMENSIONS (MM)			
SIZE	A	B	∅C
3/4"	35	64	∅15
1"	50.5	80.8	∅25.4

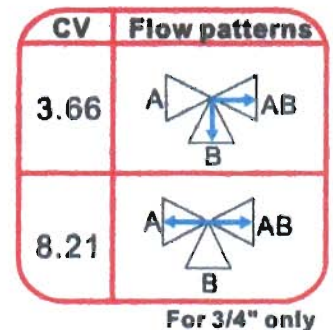

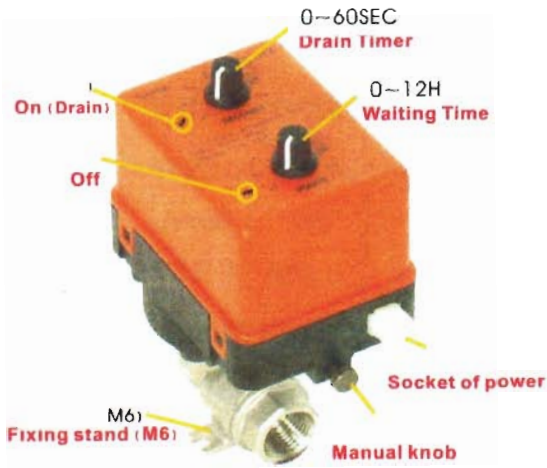

	water Normal lukewarm	Steam	Cold brine	Air condition	Chemical engineering
	●	X	X	●	X

- 1/2" (V port · BSPT)
- 2way, 2-piece
- N.W. 1.1Kg
- Body CF8M
- Working pressure Below 10kg

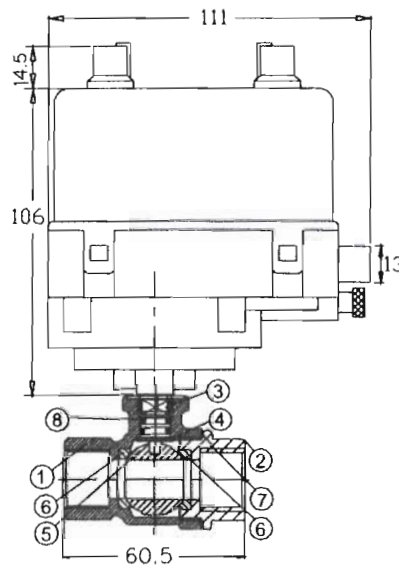
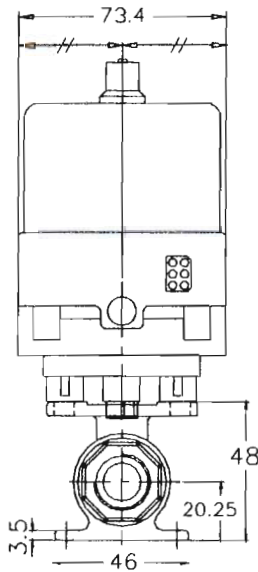
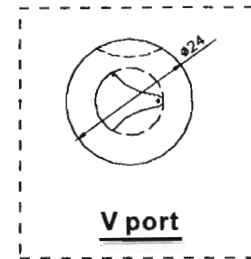

WIRING

- Black } power supply
- White } AC220V / 50-60Hz
- Green }

MATERIAL

NO.	PART NAME	MATERIAL	Q'TY
8	NBR	O-RING	2
7	TEFLON	GASKET	1
6	TEFLON	SEAT	2
5	SS316	BALL	1
4	TEFLON	THRUST WASHER	1
3	CF8M	STEM	1
2	CF8M	BODY CAP	1
1	CF8M	BODY	1

