

PC
Cover



Cover "O" ring

5.5mm indicator

- * Aux Limit Switch (OPEN) Ⓞ
- * Aux Limit Switch (CLOSE) Ⓞ
- Limit Switch (OPEN) Ⓞ
- Limit Switch (CLOSE) Ⓞ

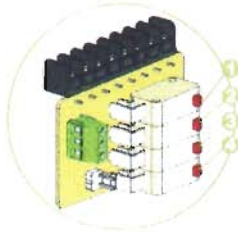

Terminal strip

Drive shaft

Linear box

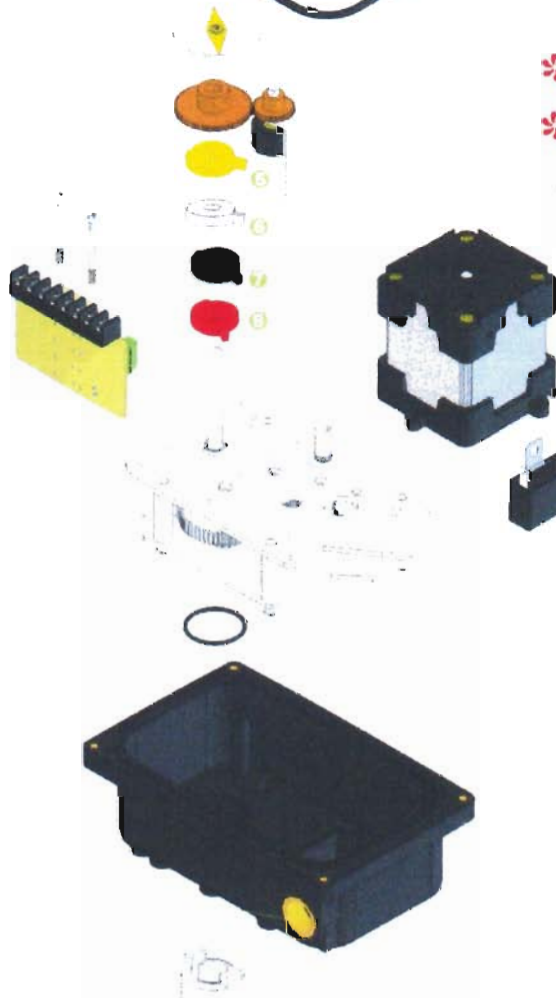

- * Ⓞ Aux Cam (Yellow - OPEN)
- * Ⓞ Aux Cam (White - CLOSE)
- Ⓞ Cam (Black - OPEN)
- Ⓞ Cam (Red - CLOSE)

Motor

Capacitor

Manual Part

1/2" x PT
Cable entries

NYLON 45GF
Base

Drive Sockets



MOTOR MODEL

#MA7



AC MOTOR
FOR 7SEC

#J860



AC MOTOR
FOR 75SEC

MANUAL PART



Specifications

Voltage	AC110V	AC220V	DC24V / 50-60Hz
Input Power (W)	23W	22W	10W
Input Current(A)	0.22A	0.1A	0.32A
On / Off Time	7sec	16sec	75sec
Torque Maxi	60N-M	40N-M	80N-M
Weatherproof	IP65		
Fluid Temperature	-20°C~+60°C		
Peripheral Moisture	Below 90%RH		
N W	2.7kg		

Description of Manual Part

MANUAL OVERRIDE

Hand / auto declutching lever for gear enage-ment , power drive automatically restored by motor start.

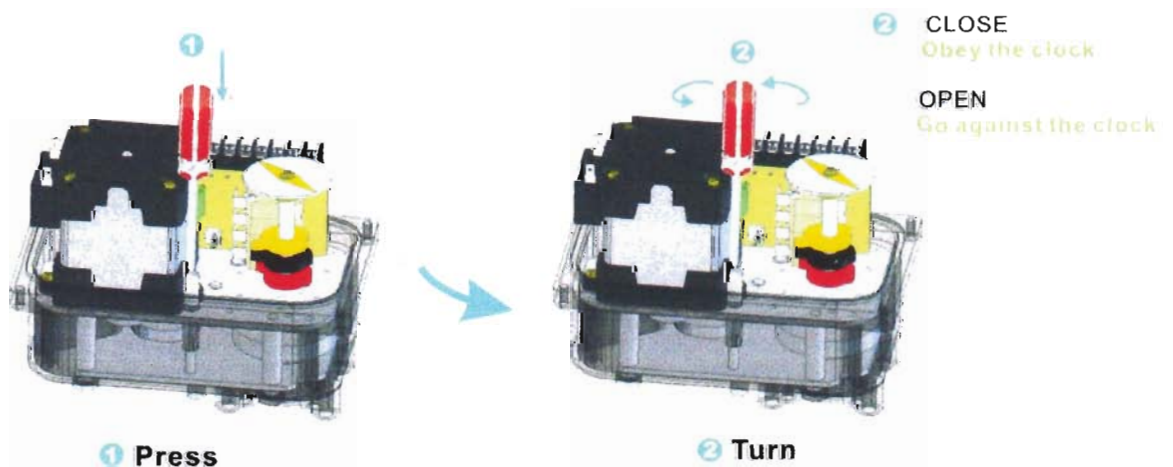

Important

Before starting the manual function, be sure to turn off the power source.

The manual operation can be done only when the actuator is not connected to the power source.

Dimensions

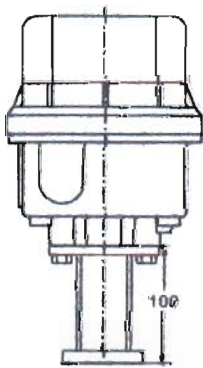
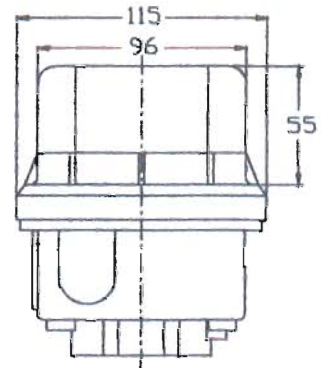
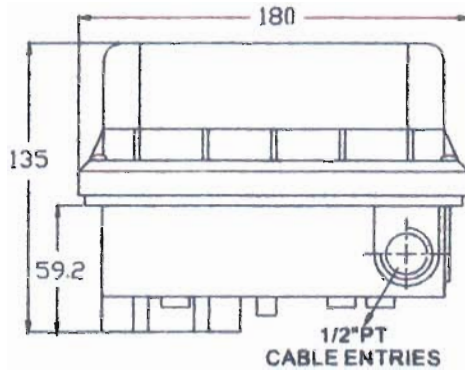
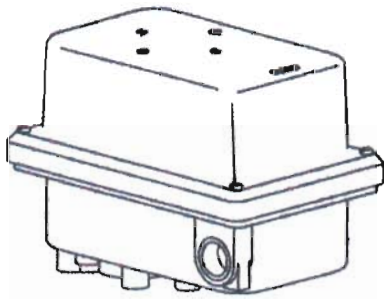

APPLICABLE RANGE FOR HEIGHT-RAISING TYPE

- High Temperature: 100°C DOWN
- Low Temperature: 3°C UP

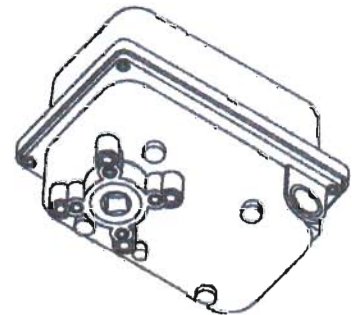

Mounting Flanged ISO5211

Mounting Flanged ISO5211

■ F05/F07

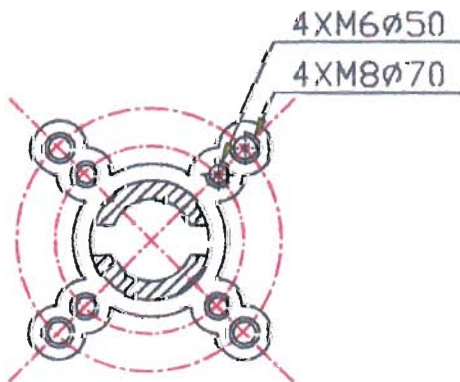

Drive Sockets

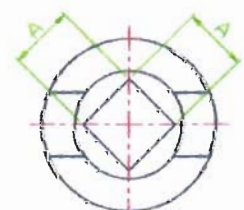
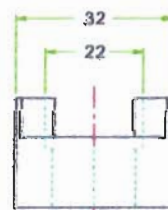

A:11mm · 14mm · 17mm



water Normal lukewarm	Steam	Cold brine	Air condition	Chemical engineering	Heat medium
●	✗	✗	●	▲	✗

- 1 1/2" ~ 2"
- 2-Piece:PT
- Full Port

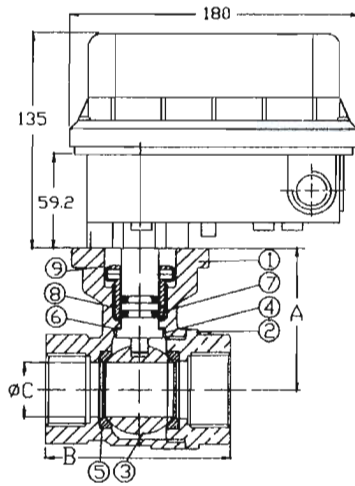
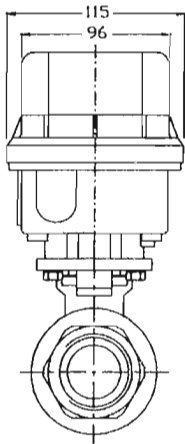

DIMENSIONS (MM)

SIZE	A	B	∅C
1-1/2"	83	100	38
2"	92	123	50

MATERIAL

NO.	Q'TY	PART NAME	MATERIAL
1	1	BODY	BRONZE C84400
2	1	BODY CAP	BRONZE C84400
3	1	BALL	FORGED BRASS
4	1	STEM	BRASS B16
5	2	SEAT	TEFLON
6	1	THRUST WASHER	TEFLON
7	2	O-RING	NBR
8	1	GLAND PACKING	TEFLON
9	1	GLAND	BRASS



water Normal lukewarm	Steam	Cold brine	Air condition	Chemical engineering	Heat medium
●	▲	▲	●	▲	✗

- 1 1/2" ~ 2"
- 3-Piece:PT
- Full Port

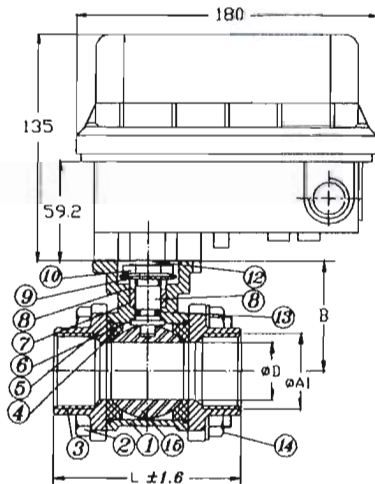
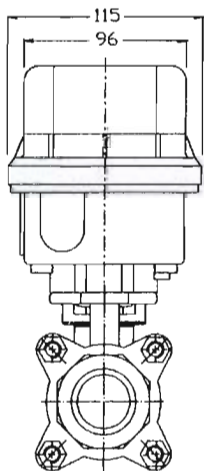

SIZE	∅D	L	∅A1	B
DN40	38.1	120	G1-1/2"	77
DN50	50.8	140	G2"	84

NO	PART NAME	Q'TY	SPECIFICATION
15	BALL	1	SUS304 SUS316
13	O-Ring	1	VITON VITON
12	STEM	1	SUS304 SUS316
10	GLAND NUT	1	CARBON STEEL A2-70
9	DISC SPRING	2	SUS301 SUS301
8	GLAND	1	SUS304 SUS304
7	STEM PACKING	1SET	PTFE PTFE
6	THRUST WASHER	1	PTFE PTFE
5	BODY GASKET	2	PTFE PTFE
4	SEATS	2	PTFE PTFE
3	END CAP	2	EN10213-2 1.0619 EN10213-4 1.4408
2	BOLT	4-6	S45C A2-70
1	BODY	1	EN10213-2 1.0619 EN10213-4 1.4408



Model: **S37-VFF** "Proportional Control Valve" Motor ball valve
FOR STEAM / COLD BRINE ONLY



water Normal lukewarm	Steam	Cold brine	Air condition	Chemical engineering	Heat medium
●	●	▲	●	▲	✗

- 1 • 1-1/2" • 2"
- Flanged: JIS10K

• V Port



V port

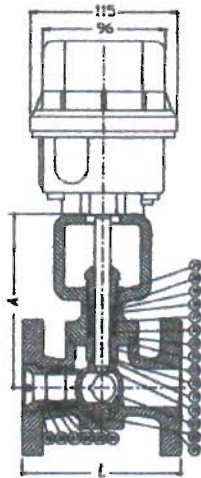
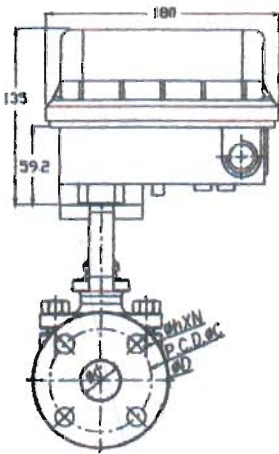

21	GLAND FLANGE	BC	01
20	WASHER	SUS304	02
19	STAY RING	BC	01
18	O-RING	VITON	01
17	GLAND PACKING	ASB+TFE	03
16	SPRING	50CrV4	04
15	BONNET	FC25	01
14	PACKING	ASB	01
13	SLEEVE	PTFE+AL	01
12	O-RING	VITON	03
11	WASHER	BC	01
10	STEM	SUS304	01
09	O RING	VITON	01
08	STAY RING	SUS304	01
07	O-RING	VITON	01
06	SPRING	50CrV4	06
05	SEAT RING	SUS304	01
04	SLAI	PIIL+GRAPHIIL	01
03	BALL	SCS13	01
02	BALL SEAT	BC	01
01	BODY	FC25	01
ITEM	SUBJECT	MATERIAL	Q'ty

FLANGE: JIS 10K
 VPA: STEAM
 VPB: CHILL WATER

DIMENSIONS:

	1"	1-1/2"	2"
∅d	25	40	50
∅C	90	105	120
∅D	125	140	155
∅hXN	∅19X4	∅19X4	∅19X4
L	127	165	178
A	178	183	189
B	293	298	304

Model: **S37-2SF** Motor ball valve



water Normal lukewarm	Steam	Cold brine	Air condition	Chemical engineering	Heat medium
●	▲	▲	●	▲	✗

- 1 1/4" ~ 2"

• Flanged: JIS10K / 150lb / 300lb

• Full Port

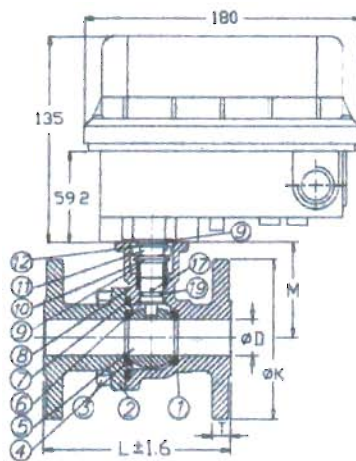
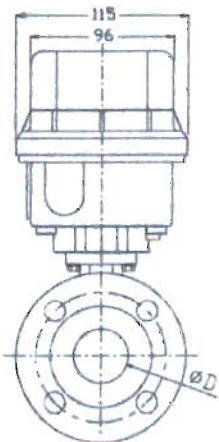

SIZE	∅D	L	∅K	T	M
1-1/4"	32	140	135	16	60
1-1/2"	40	165	140	16	80
2"	50	178	155	16	86

NO	PART NAME	Q'TY	SPECIFICATION
19	O-Ring	1	VITON
17	ANTI STATIC (optional)	1	SUS304
12	TAB WASHER	1	SUS304
11	GLAND NUT	1	SUS304
10	DISC SPRING	2	SUS301
9	GLAND	2	SUS304
8	GLAND PACKING	4	PTFE
7	GASKET	1	PTFE
6	THRUST WASHER	1	PTFE
5	BALL	1	SUS316 or CFBM
4	SEAT	2	RPTFE
3	HEX BOLT	4	SUS304
2	END CAP	1	CFBM
1	BODY	1	CFBM

Model: **S37-BFN**

Motor Butterfly valve



water Normal lukewarm	Steam	Cold brine	Air condition	Chemical engineering	Heat medium
●	✗	✗	●	▲	✗

- 2" ~ 4"
- Flanged: JIS10K / 125lb / 150lb
- Full Port

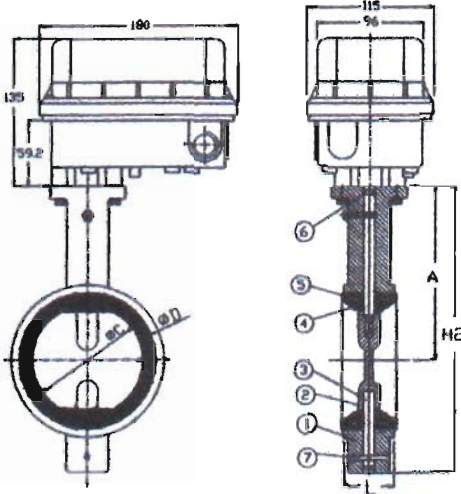

SIZE	L	H2	A	C	D
50	43	201	136	56	83
65	46	224	146	66	92
80	46	240	152	84	112
100	52	288	171	105	136

ITEM	PARTS	MATERIAL
1	BDY	FC20/CF8
2	DISC	FCD 450 SCS 13
3	STEM	SUS 304
4	IRFN RING	GCD 450
5	SEAT	NBR/EPDM/VITON
6	PI-RING	NBR
7	SPRING PIN	CARBON STEEL



Anti Dew Condensation
Model: S37-TBU

PARTS	MATERIAL
BDY	Aluminum Diecast Alloy
DISC	SCS 13
STEM	SUS 304
SEAT	NBR/EPDM

Nominal size	Dimension(mm)						Drive Sockets
	mm	inch	C	D	L	H2	
40	1 1/2	45	80	35	193	132	
50	2	52	91	43	204	138	
65	2 1/2	65	111	46	223	151	8
80	3	80	127	46	241	156	10
100	4	101	147	52	265	167	12

Model: **S37-3ST**

Motor ball valve



water Normal lukewarm	Steam	Cold brine	Air condition	Chemical engineering	Heat medium
●	✗	▲	●	▲	✗

- 1-1/2" ~ 2"
- Standard
- 3way · PT

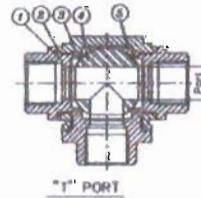
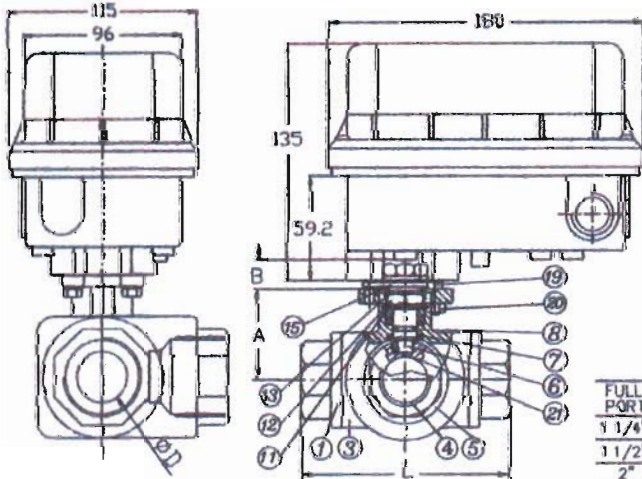
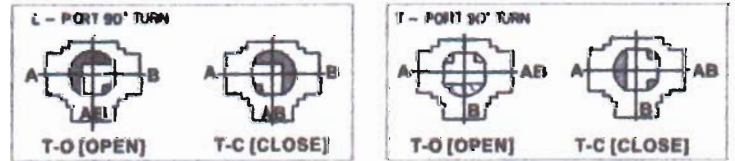

FULL PORT	STANDARD PORT	A	B	E	L	H	Port
1 1/4"	1 1/2"	63	18	98	125	80	32
1 1/2"	2"	74	18	103	149	80	40
2"	*	93	22	140	174	80	50

No	NAME OF PARTS	MATERIALS
1	END CAP	A351 Gr. CF8M
2	GASKET	PTFE
3	BODY	A351 Gr. CF8M
4	BALL	SS316
5	SEATS	RPTFE+CARBON
6	STEM	SS316
7	THRUST WASHER	RPTFE
8	O-RING	VITON
7f	O-RING WASHER	SS301
12	STEM NUT	SS304
13	NUT STOP	SS304
15	FLATER STOPPER	SS304
18	STOP PIN	SS304
20	STOP PIN NUT	SS304
21	PIN	SS316