

**Annotate**

\* Symbol is optional component.

## Specifications

### Hand-wheel



### S200

### S202

<b>Voltage :</b> AC110V	AC220V	AC110V	AC220V
<b>Input Power (W) :</b> 300W	300W	50W	50W
<b>Input Current(A) :</b> 4.14A	1.38A	4.14A	1.38A
<b>On / Off Time :</b> 10sec		80sec	
<b>Torque Maxi :</b> 300N-M		500N-M	
<b>Weatherproof :</b> IP66		<b>Double planetary gear</b>	
<b>Fluid Temperature :</b> -20°C~+60°C			
<b>Peripheral Moisture :</b> Below 90%RH			
<b>N.W.</b> 18.5kg			

### S200

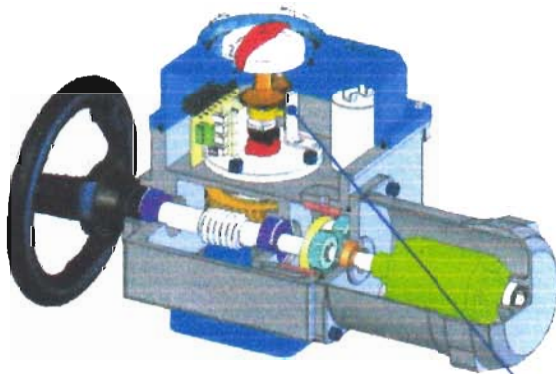

### S202

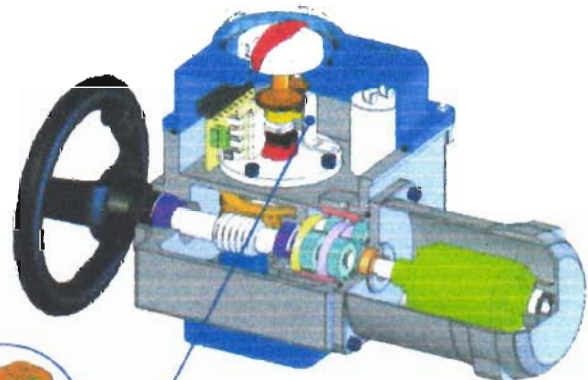

### Double planetary gear

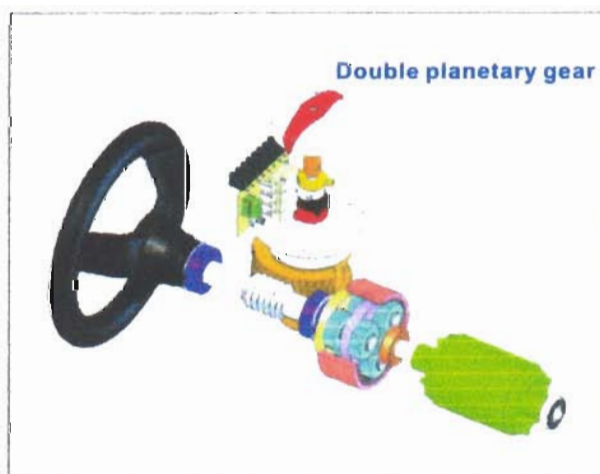

# Dimensions

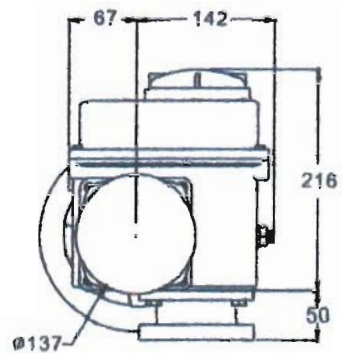
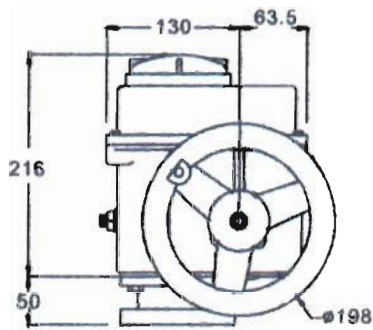
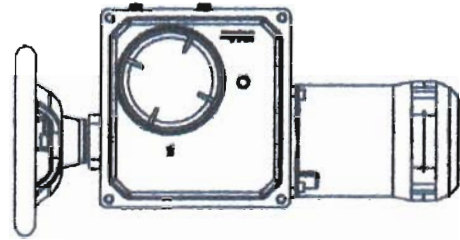
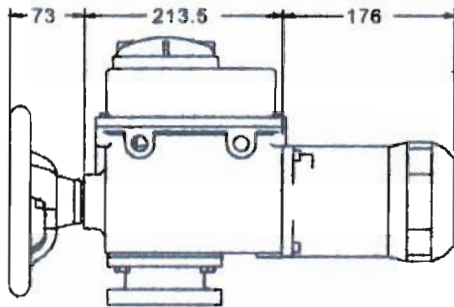

## Mounting Flanged ISO5211

■ F10/F12

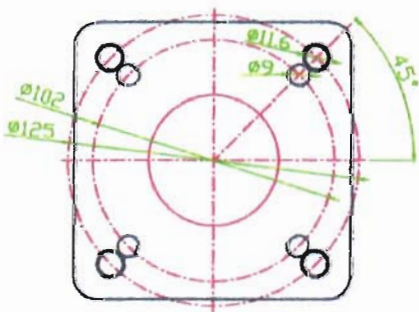

### Drive Sockets

A: 17mm · 19mm · 22mm  
25mm · 27mm

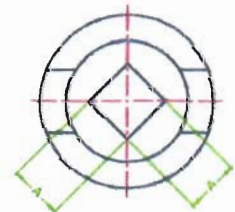
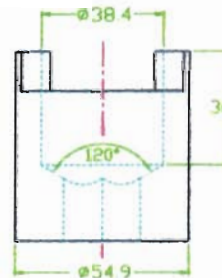
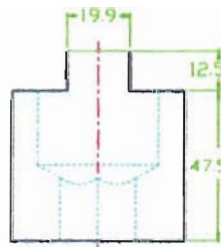

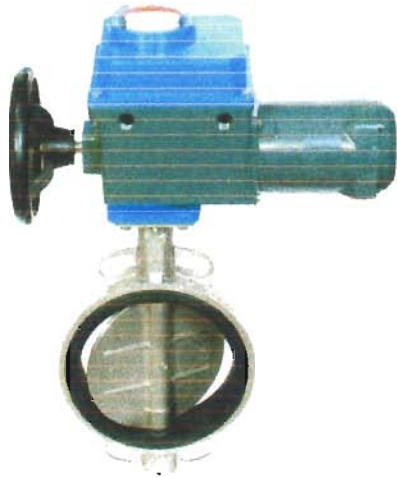

### Specifications

- 1. Size Range  
200mm~350mm
- 2. Working Pressure  
10kg
- 3. End Connections  
ANSI Class 125 & 150  
JIS10K

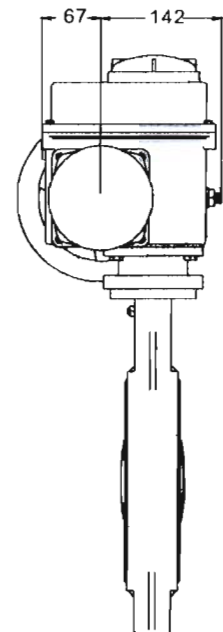
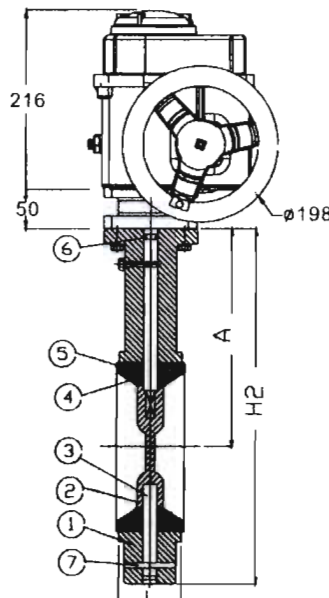
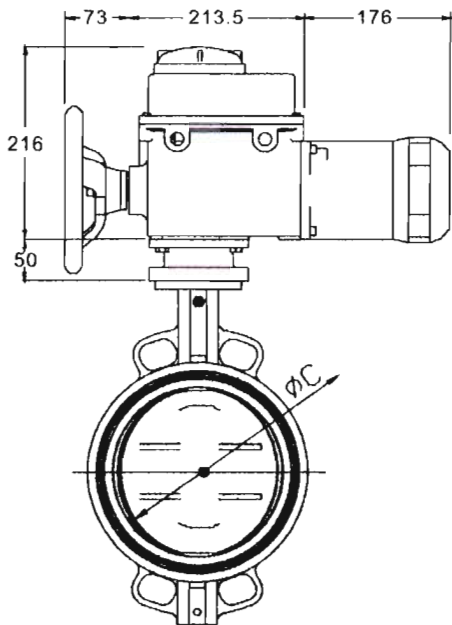

**Π MATERIAL OF CONSTRUCTION**

ITEM	PARTS	MATERIAL
1	BODY	FC20/CF8
2	DISC	FCD 450   SCS 13
3	STEM	SUS 304
4	IRON RING	GCD 450
5	SEAT	NBR/EPDM/VITON
6	Π-RING	NBR
7	SPRING PIN	CARBON STEEL

in	SIZE	L	H2	A	C
8	200	60	402	226	202
10	250	68	468	258	250
12	300	78	544	293	299
14	350	78	588	318	328